

HOUSING WITH CONTACT

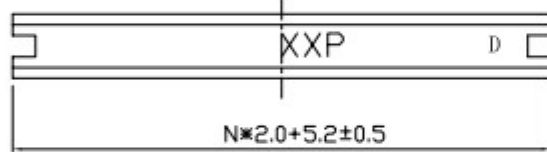

COVER

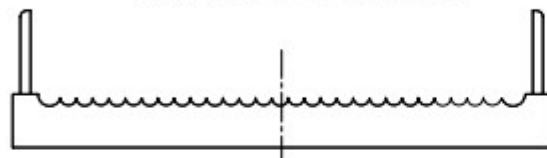

DOWN COVER

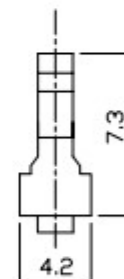
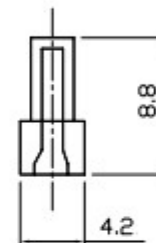
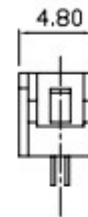

NOTES:

1. MATERIAL

- 1.1 INSULATOR: THERMOPLASTIC (UL 94V-0).
- 1.2 CONTACT: COPPER ALLOY.

2. SPECIFICATION

- 2.1 STORAGE TEMPERATURE:  $-20 - 70^{\circ}\text{C}$ .
- 2.2 OPERATING TEMPERATURE:  $0 - 85^{\circ}\text{C}$ .
- 2.3 CONTACT RESISTANCE:  $20\text{m}\Omega$  max.
- 2.4 INSULATION RESISTANCE:  $1000\text{M}\Omega$  min.
- 2.5 DIELECTRIC WITHSTANDING VOLTAGE: AC 500V PER MINUTE.

3. No. OF CONTACTS

- 10 12 16 20 22 24 26 34 36 40 44 50 56 68