

REVISION RECORD			
REV	ECN	DESCRIPTION	DATE

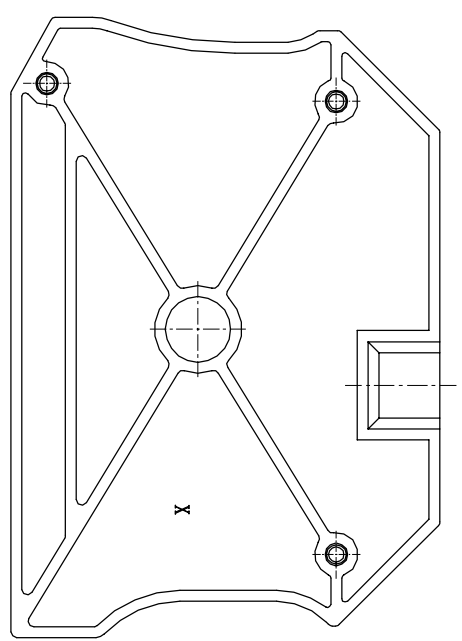
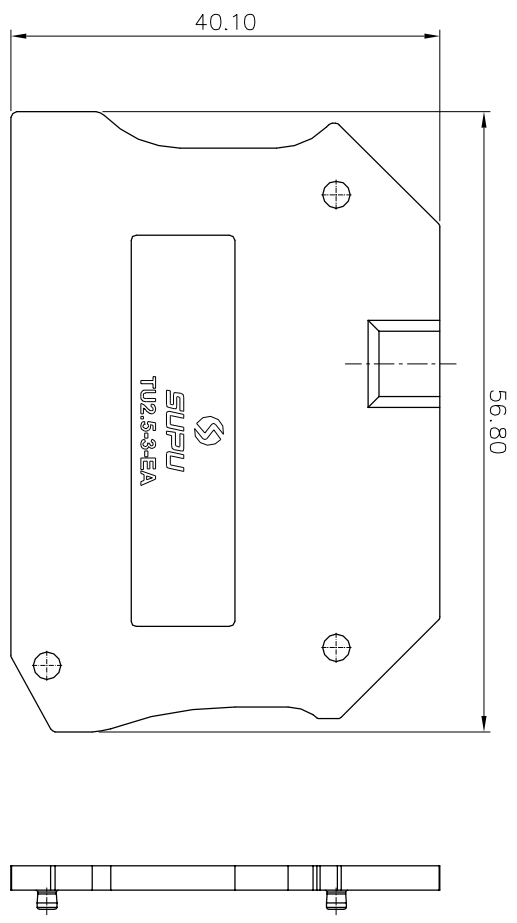
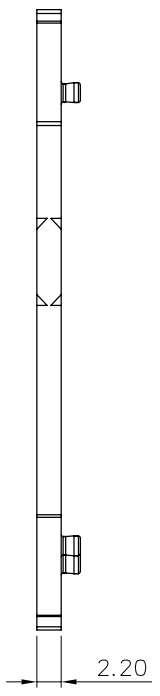

Transmittal, reproduction, dissemination and/or editing of this document as well as utilization of its contents and communication thereof to others without express authorization are prohibited.
 未经允许禁止传输、复制、编辑该文档，以及利用其内容进行交流

普通用作件登记
Common Part
原图号
Old Draw. No.
底图总号
Assembly No.

Material: Insulator PAGE UL94 V-0

General information:
 1. Dimension shall be interpreted per ASME Y14.5-2009
 2. Operating temperature: -40°C~+105°C
 3. RoHS Compliance
 4. Undimensioned Tolerances:

HOW TO ORDER:
 TU2.5-3-XX-EA
 Series No. Color: GY: Grey, OG: Orange, BU: Blue

Pitch Range		Nominal Dimension		Range		
mm	In mm	mm	In mm	mm	In mm	
Over 6	Over 10	Over 30	Over 60	Over 100	Over 150	0.1/10
TO 10	TO 24	TO 30	TO 60	TO 100	TO 150	<
±0.15	±0.20	±0.30	±0.50	±0.70	±1.00	±2°

订货号 Order No.	项目 Item	设计 Design	审核 Check	工艺 Process	标准化 Unity	批准 批注	日期 Date	签字 Signature	名称 Name	图号 Drawing No.	材料 Material	物料号 Item No.	未注公差 Tolerance	表面 Surface	重量 Weight	比例 Scale
TU2.5-3-XX-EA	DF	DF	CW	-	-	LWL	2020.10.16		TU系列2.5mm2铁螺 钉一进二出盖板	PRM002396	Notes					
									版本号 Revision Number	M1		第1页/共1页 1 of 1				

表面
Surface
VDI21
比例
Scale
1:1
mm

宁波普电子有限公司
NINGBO SUPU ELECTRONICS CO., LTD.