

STANDARD CRIMP

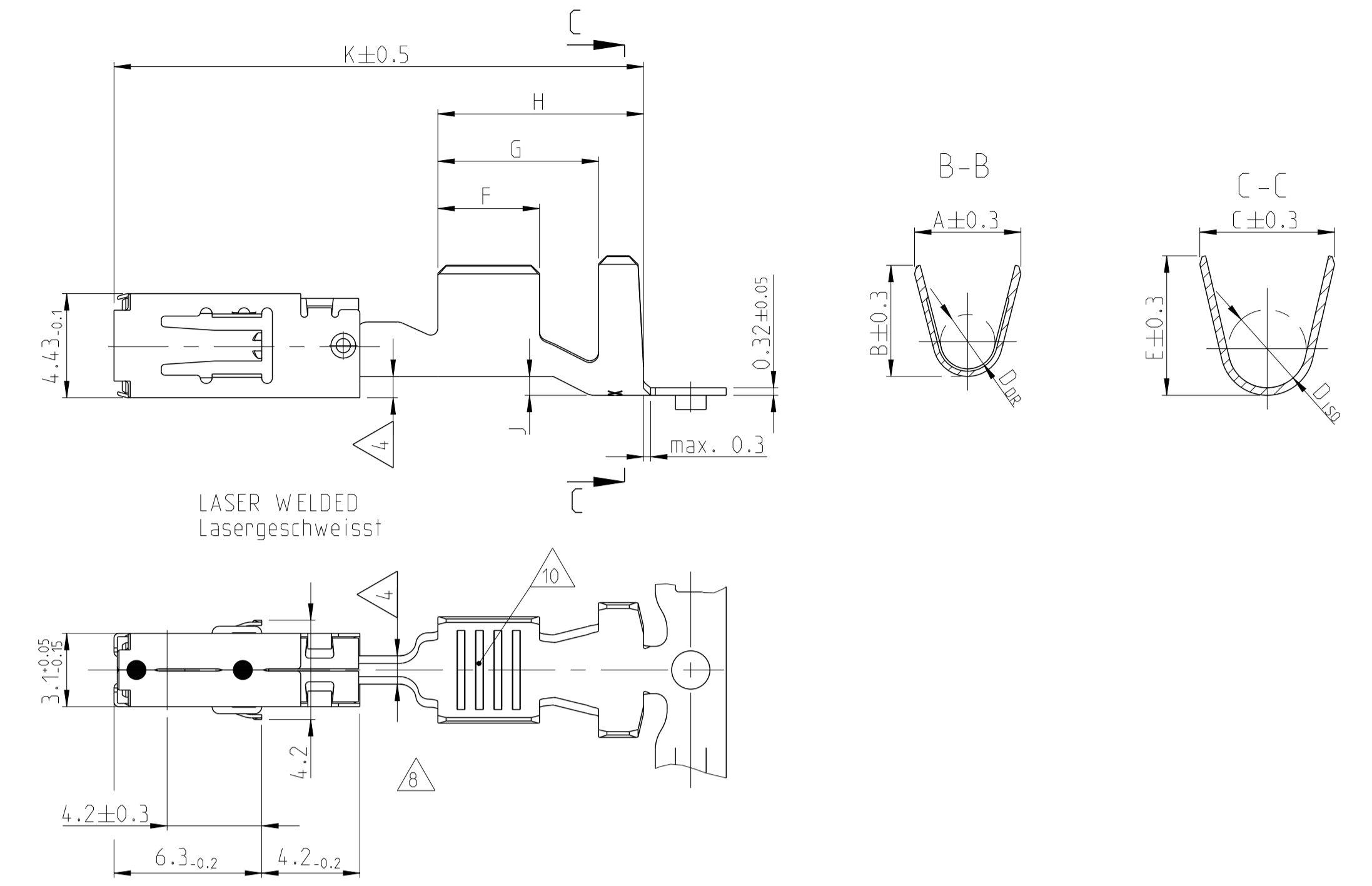

SERRATION DESIGN Serration Ausfuehrung (F14)

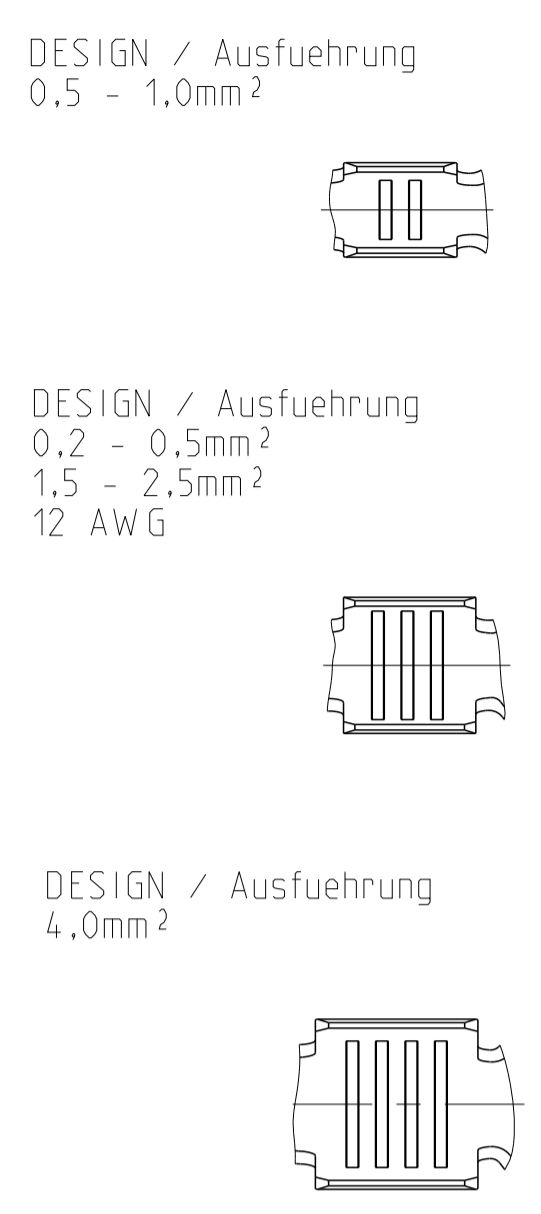

SINGLE WIRE SEAL Einzeldichtungssystem

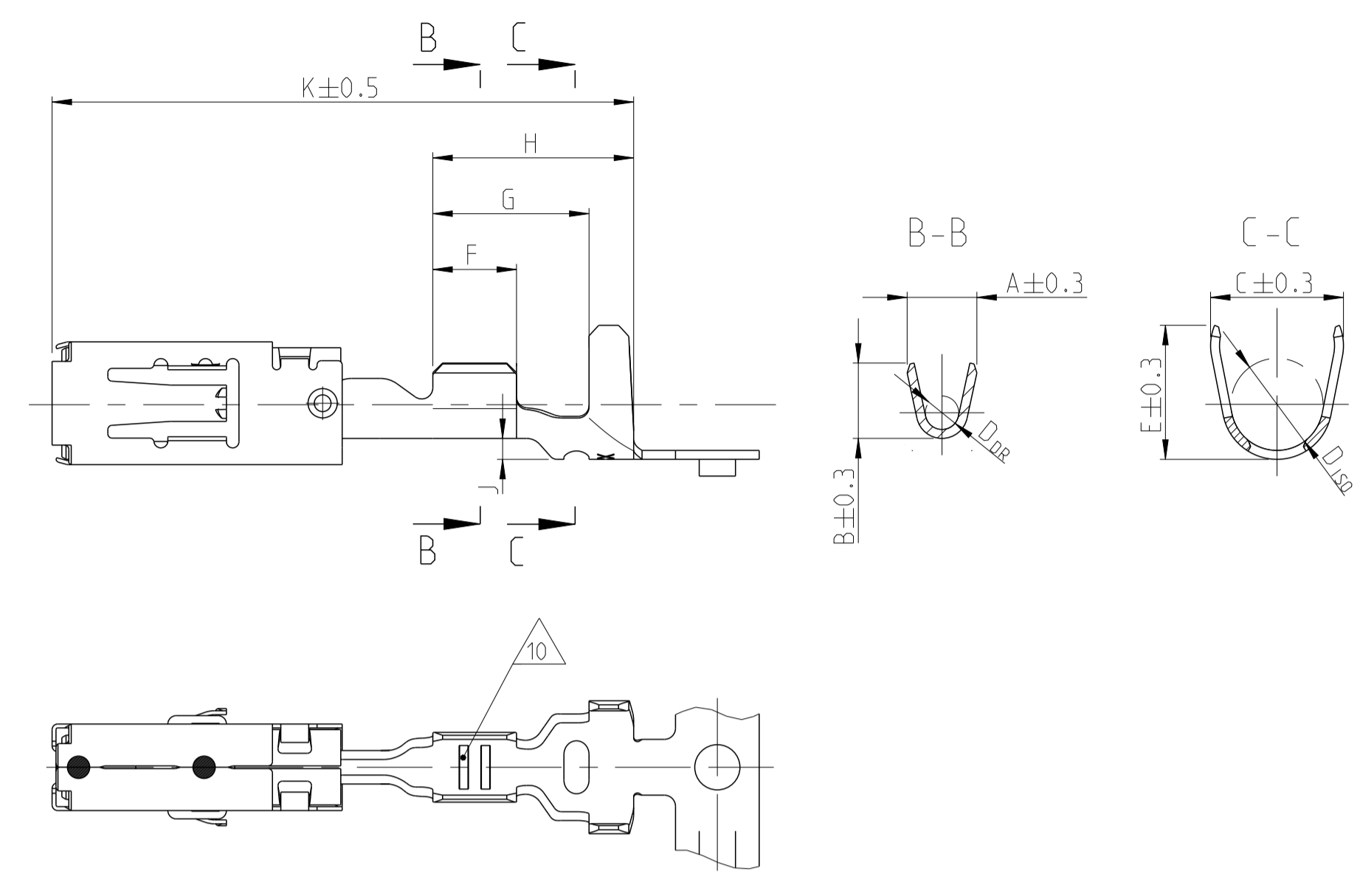

REVISIONS				
P	LTN	DESCRIPTION	DATE	APPROV
J11		NOTE B ADDED. TABLE UPDATE WITH PNs 1-...-4	17MAY2017	MAH. SBEC
J12		PNs 1-968855-4, 1-968857-4, 1-968859-4 OBSOLETE ON DRW.	05MAR2018	MAH. SBEC
J13		Added PN 2-968851-3, 2-968853-3 2-968857-3 and 2-968859-3	07MAY2018	FRAN. BECK
J14		Obsolete PN 1-968882-1/-2/-3; PN 1-968880-1/-3	11NOV2020	FRAN. BECK

NOTES:
Bemerkungen:

- 1 MATING PART SEE INTERFACE DRAWING
TE-NO.: 114-18230-002
Gegensecker nach Ausfuehrungsvorschrift
TE-Nr.: 114-18230-002
- 2 SURFACE:
- PRE TIN PLATED 1 TO 3 µm
- GOLD PLATED MIN. 2 µm (ONLY CONTACT AREA)
- SILVER PLATED 3 TO 5 µm (ONLY CONTACT AREA)
Oberflaeche:
- verzinkt 1 bis 3 µm
- vergoldet min. 2 µm (nur Kontaktzone)
- versilbert 3 bis 5 µm (nur Kontaktzone)
- 3 DOUBLE CRIMPS ARE ONLY POSSIBLE WITH APPLICATORS AUTHORIZED BY TE (NO HAND TOOL) SUITABLE TOOLS ON REQUEST
Doppelanschlaege sind nur mit von TE zugelassenen Anschlagwerkzeugen moeglich (keine Handzangen) passende Werkzeuge auf Anfrage
- 4 GAUGE INSPECTION
Lehrenpruefung
- 5 DETAILS OF DESIGN ARE LEFT TO MANUFACTURER
Einzelheiten der Ausfuehrung bleiben dem Hersteller ueberlassen
- 6 ONLY GERMAN LANGUAGE VERSION SHALL BE BINDING
Massgebend ist der deutsche Text
- 7 PUNCHING OIL RAZIOL CLF 11 SG
Stanzoeel:
- 8 "Ag+" MARKING ON SILVER PLATED VERSIONS FOR INCREASED LIMIT TEMPERATURE
"Ag+" Markierung auf versilberten Versionen fuer erhoehnte Grenztemperatur
- 9 968880 nicht fuer Neuanwendungen, wird ersetzt durch 2141857
968882 nicht fuer Neuanwendungen, wird ersetzt durch 2141859
968880 SUPERSEDED BY PN 2141857
968882 SUPERSEDED BY PN 2141859
- 10 Unterschiedliche Ausfuehrung und Anzahl der Rillen moeglich
DIFFERENT FORM AND NUMBER OF THE SERRATIONS POSSIBLE

VERSION	Ausfuehrung	ORDER-NO. STRIP-FORM	Bestell-Nr. Bandware	REV	MATERIAL	BODY	SPRING	SURFACE	Oberflaeche	WIRE SIZE RANGE	INSULATION DIAMETER	CRIMP DIMENSIONS / Crimpabmessungen mm											WEIGHT	SINGLE WIRE SEAL	TE CONNECTIVITY NO.	DEAD END PLUG	Blindstopfen	TE CONNECTIVITY NO.	APPLICATION TOOLS	Verarbeitungswerkzeuge												
												A	B	^D DR	C	E	^D ISO	F	G	H	J	K									g											
		1-1719506-3	A		SILVER PLATED versilbert					12 AWG	3.0	4.0	4.2	2.0	5.0	5.0	3.5	3.5	5.9	7.5	0.8	21.0	0.59	828905-1	828922-1																	
		1-1719506-1	A		PRE TIN PLATED verzinkt						3.8																															
		2-968859-3	D		SILVER PLATED versilbert					4	3.4	4.5	4.7	2.3	6.0	6.0	4.3	4.3	7.0	8.5	1.25	22.6	0.65	828985-1	828986-1																	
		1-968859-3	E		SILVER PLATED versilbert																																					
		1-968859-1	E		PRE TIN PLATED verzinkt						3.7																															
		2-968857-3	B		SILVER PLATED versilbert					1.5	2.2	3.6	3.8	1.7	5.0	5.0	3.5	3.5	6.0	7.6	0.8	21.0	0.58	828905-1	828922-1																	
		1-968857-3	E		SILVER PLATED versilbert																																					
		1-968857-2	D		GOLD PLATED vergoldet					2.5	3.0																															
		1-968857-1	E		PRE TIN PLATED verzinkt																																					
		1-968855-3	E		SILVER PLATED versilbert					0.5	1.4	2.5	2.7	1.2	4.8	4.8	3.3	3.0	5.6	7.2	0.75	21.0	0.54	828904-1	828922-1																	
		1-968855-2	E		GOLD PLATED vergoldet																																					
		1-968855-1	E		PRE TIN PLATED verzinkt					1.0	2.1																															
		1-2141859-3	A		SILVER PLATED versilbert					0.2	1.2	2.4	2.3	1.0	4.5	4.5	3.2	2.5	5.1	6.7	0.75	21.0	0.52	828904-1	828922-1																	
		1-2141859-2	A		GOLD PLATED vergoldet																																					
		1-2141859-1	A		PRE TIN PLATED verzinkt					0.5	1.4																															
		1-968882-3	E		SILVER PLATED versilbert					0.2	1.2	2.1	2.1	0.8	4.5	4.5	3.2	2.5	5.1	6.7	0.75	21.0	0.52	828904-1	828922-1																	
		1-968882-2	E		GOLD PLATED vergoldet																																					
		1-968882-1	E		PRE TIN PLATED verzinkt					0.5	1.4																															
		2-968853-3	D		SILVER PLATED versilbert					4	2.7	4.5	4.7	2.3	5.7	5.9	3.3	4.3	6.8	8.7	0.8	22.6	0.65	-	-																	
		1-968853-3	E		SILVER PLATED versilbert																																					
		1-968853-1	E		PRE TIN PLATED verzinkt						3.7																															
		2-968851-3	D		SILVER PLATED versilbert					1.5	2.2	3.6	3.8	1.7	4.6	5.0	2.6	3.5	5.1	6.7	0.3	20.2	0.56	-	-																	
		1-968851-3	E		SILVER PLATED versilbert																																					
		1-968851-2	E		GOLD PLATED vergoldet					2.5	3.0																															
		1-968851-1	E		PRE TIN PLATED verzinkt																																					
		1-968849-3	E		SILVER PLATED versilbert					0.5	1.4	2.5	2.7	1.2	3.3	3.5	1.8	3.0	4.6	6.2	0.2	20.2	0.51	-	-																	
		1-968849-2	E		GOLD PLATED vergoldet																																					
		1-968849-1	E		PRE TIN PLATED verzinkt					1.0	2.1																															
		1-2141857-3	A		SILVER PLATED versilbert					0.2	1.2	2.4	2.3	1.0	2.9	2.9	1.4	2.5	3.8	5.7	0.2	20.2	0.48	-	-																	
		1-2141857-1	A		PRE TIN PLATED verzinkt					0.5	1.4																															
		1-968880-3	E		SILVER PLATED versilbert					0.2	1.2	2.1	2.1	0.8	2.9	2.9	1.4	2.5	3.8	5.7	0.2	20.2	0.48	-	-																	
		1-968880-1	E		PRE TIN PLATED verzinkt					0.5	1.4																															

SEE APPLICATION SPECIFICATION 114-18148
siehe Verarbeitungsspezifikation 114-18148

THIS DRAWING IS A CONTROLLED DOCUMENT.		OWN S. Blidar	22SEP97	 TE Connectivity PRODUCT GROUP DRAWING FOR Tabellenzeichnung fuer AMP MCP 2.8
DIMENSIONS:	TOLERANCES UNLESS OTHERWISE SPECIFIED:	CHK G. Hotea	22SEP97	
mm	PLC ±0.2	APVD J. Woller	NAME	
			APPLICATION SPEC	
MATERIAL	FINISH	WEIGHT	SIZE CAGE CODE DRAWING NO	RESTRICTED TO
-	-	-	A1 00779 ©=1355036	-
CUSTOMER DRAWING			SCALE 5:1	SHEET 1 OF 1
			REV J14	