

1.00mm CENTER FLAT FLEX CABLE (FFC) (EXTRA FLEXIBLE, 105°C, Sn PLATED)

| "L" DIM. → | 30 ± 2 MM | | 51 ± 2 MM | | 76 ± 3 MM | | 102 ± 3 MM | | 127 ± 4 MM | | 152 ± 4 MM | | 178 ± 4 MM | | 203 ± 4 MM | | 229 ± 5 MM | | 254 ± 5 MM | | 305 ± 5 MM | | | |
|--------------|-------------|-----------|------------|-----------|------------|-----------|------------|-----------|------------|-----------|------------|-----------|------------|-----------|------------|-----------|------------|-----------|-------------|-----------|-------------|-----------|---|--|
| REF DIM → | (1.18 INCH) | | (2 INCHES) | | (3 INCHES) | | (4 INCHES) | | (5 INCHES) | | (6 INCHES) | | (7 INCHES) | | (8 INCHES) | | (9 INCHES) | | (10 INCHES) | | (12 INCHES) | | | |
| CABLE TYPE → | A | | D | | A | | D | | A | | D | | A | | D | | A | | D | | A | | D | |
| CIRCUITS ↓ | A | D | A | D | A | D | A | D | A | D | A | D | A | D | A | D | A | D | A | D | A | D | | |
| 4 | 151670701 | 151670700 | 151670703 | 151670702 | 151670705 | 151670704 | 151670707 | 151670706 | 151670709 | 151670708 | 151670711 | 151670710 | 151670713 | 151670712 | 151670715 | 151670714 | 151670717 | 151670716 | 151670719 | 151670718 | 151670721 | 151670720 | | |
| 6 | 151670201 | 151670202 | 151670203 | 151670204 | 151670205 | 151670206 | 151670207 | 151670208 | 151670209 | 151670210 | 151670211 | 151670212 | 151670213 | 151670214 | 151670215 | 151670216 | 151670217 | 151670218 | 151670219 | 151670220 | 151670221 | 151670222 | | |
| 8 | 151670223 | 151670224 | 151670225 | 151670226 | 151670227 | 151670228 | 151670229 | 151670230 | 151670231 | 151670232 | 151670233 | 151670234 | 151670235 | 151670236 | 151670237 | 151670238 | 151670239 | 151670240 | 151670241 | 151670242 | 151670243 | 151670244 | | |
| 10 | 151670245 | 151670246 | 151670247 | 151670248 | 151670249 | 151670250 | 151670251 | 151670252 | 151670253 | 151670254 | 151670255 | 151670256 | 151670257 | 151670258 | 151670259 | 151670260 | 151670261 | 151670262 | 151670263 | 151670264 | 151670265 | 151670266 | | |
| 12 | 151670267 | 151670268 | 151670269 | 151670270 | 151670271 | 151670272 | 151670273 | 151670274 | 151670275 | 151670276 | 151670277 | 151670278 | 151670279 | 151670280 | 151670281 | 151670282 | 151670283 | 151670284 | 151670285 | 151670286 | 151670287 | 151670288 | | |
| 14 | 151670289 | 151670290 | 151670291 | 151670292 | 151670293 | 151670294 | 151670295 | 151670296 | 151670297 | 928670298 | 151670299 | 151670300 | 151670301 | 151670302 | 151670303 | 151670304 | 151670305 | 151670306 | 151670307 | 151670308 | 151670309 | 151670310 | | |
| 16 | 151670311 | 151670312 | 151670313 | 151670314 | 151670315 | 151670316 | 151670317 | 151670318 | 151670319 | 151670320 | 151670321 | 151670322 | 151670323 | 151670324 | 151670325 | 151670326 | 151670327 | 151670328 | 151670329 | 151670330 | 151670331 | 151670332 | | |
| 18 | 151670333 | 151670334 | 151670335 | 151670336 | 151670337 | 151670338 | 151670339 | 151670340 | 151670341 | 151670342 | 151670343 | 151670344 | 151670345 | 151670346 | 151670347 | 151670348 | 151670349 | 151670350 | 151670351 | 151670352 | 151670353 | 151670354 | | |
| 20 | 151670355 | 151670356 | 151670357 | 151670358 | 151670359 | 151670360 | 151670361 | 151670362 | 151670363 | 151670364 | 151670365 | 151670366 | 151670367 | 151670368 | 151670369 | 151670370 | 151670371 | 151670372 | 151670373 | 151670374 | 151670375 | 151670376 | | |
| 22 | 151670377 | 151670378 | 151670379 | 151670380 | 151670381 | 151670382 | 151670383 | 151670384 | 151670385 | 151670386 | 151670387 | 151670388 | 151670389 | 151670390 | 151670391 | 151670392 | 151670393 | 151670394 | 151670395 | 151670396 | 151670397 | 151670398 | | |
| 24 | 151670399 | 151670400 | 151670401 | 151670402 | 151670403 | 151670404 | 151670405 | 151670406 | 151670407 | 151670408 | 151670409 | 151670410 | 151670411 | 151670412 | 151670413 | 151670414 | 151670415 | 151670416 | 151670417 | 151670418 | 151670419 | 151670420 | | |
| 26 | 151670421 | 151670422 | 151670423 | 151670424 | 151670425 | 151670426 | 151670427 | 151670428 | 151670429 | 151670430 | 151670431 | 151670432 | 151670433 | 151670434 | 151670435 | 151670436 | 151670437 | 151670438 | 151670439 | 151670440 | 151670441 | 151670442 | | |
| 28 | 151670443 | 151670444 | 151670445 | 151670446 | 151670447 | 151670448 | 151670449 | 151670450 | 151670451 | 151670452 | 151670453 | 151670454 | 151670455 | 151670456 | 151670457 | 151670458 | 151670459 | 151670460 | 151670461 | 151670462 | 151670463 | 151670464 | | |
| 30 | 151670465 | 151670466 | 151670467 | 151670468 | 151670469 | 151670470 | 151670471 | 151670472 | 151670473 | 151670474 | 151670475 | 151670476 | 151670477 | 151670478 | 151670479 | 151670480 | 151670481 | 151670482 | 151670483 | 151670484 | 151670485 | 151670486 | | |
| 32 | 151670487 | 151670488 | 151670489 | 151670490 | 151670491 | 151670492 | 151670493 | 151670494 | 151670495 | 151670496 | 151670497 | 151670498 | 151670499 | 151670500 | 151670501 | 151670502 | 151670503 | 151670504 | 151670505 | 151670506 | 151670507 | 151670508 | | |
| 34 | 151670509 | 151670510 | 151670511 | 151670512 | 151670513 | 151670514 | 151670515 | 151670516 | 151670517 | 151670518 | 151670519 | 151670520 | 151670521 | 151670522 | 151670523 | 151670524 | 151670525 | 151670526 | 151670527 | 151670528 | 151670529 | 151670530 | | |
| 36 | 151670531 | 151670532 | 151670533 | 151670534 | 151670535 | 151670536 | 151670537 | 151670538 | 151670539 | 151670540 | 151670541 | 151670542 | 151670543 | 151670544 | 151670545 | 151670546 | 151670547 | 151670548 | 151670549 | 151670550 | 151670551 | 151670552 | | |
| 38 | 151670553 | 151670554 | 151670555 | 151670556 | 151670557 | 151670558 | 151670559 | 151670560 | 151670561 | 151670562 | 151670563 | 151670564 | 151670565 | 151670566 | 151670567 | 151670568 | 151670569 | 151670570 | 151670571 | 151670572 | 151670573 | 151670574 | | |
| 40 | 151670575 | 151670576 | 151670577 | 151670578 | 151670579 | 151670580 | 151670581 | 151670582 | 151670583 | 151670584 | 151670585 | 151670586 | 151670587 | 151670588 | 151670589 | 151670590 | 151670591 | 151670592 | 151670593 | 151670594 | 151670595 | 151670596 | | |

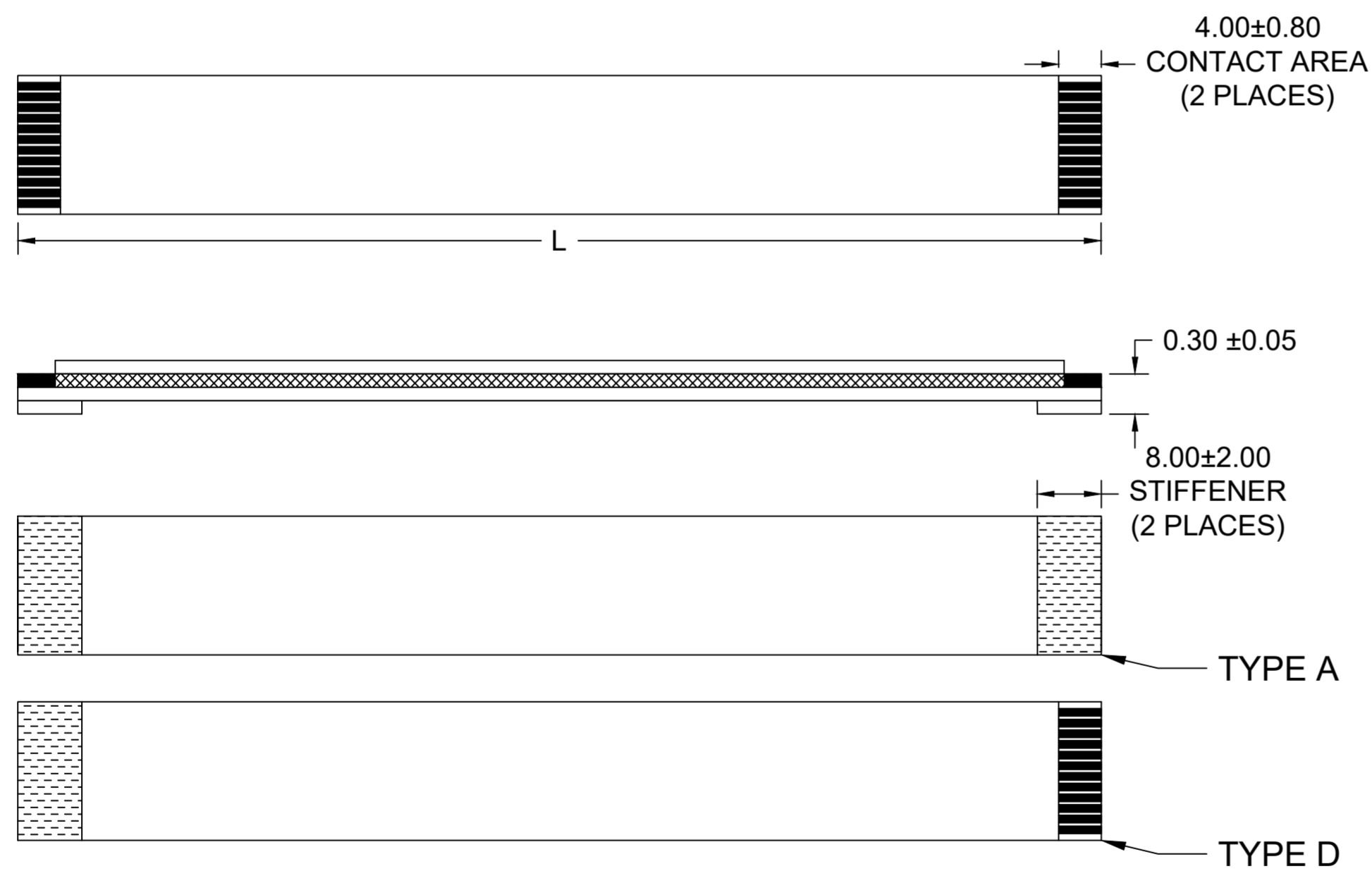

NOTES:

- NO PRINTING ON JUMPER CABLE UNLESS OTHERWISE SPECIFIED. IF PRINTING IS REQUIRED, THEN IT WOULD BE CONSIDERED A SPECIAL JUMPER CABLE.
- FOR ODD CIRCUIT COUNT, CROSS-SECTION AND END-TAIL DETAIL REFER TO SHEET # 2

THIS DRAWING CONTAINS INFORMATION THAT IS PROPRIETARY TO MOLEX ELECTRONIC TECHNOLOGIES, LLC AND SHOULD NOT BE USED WITHOUT WRITTEN PERMISSION

| | | | | | | | | | | | | | | | |
|--|--|-------|-------|--------------------------------------|--|-----------------|--|---|--|----------------------------|--|--------------------------|--|----------------------|--|
| DIMENSION UNITS | | SCALE | | CURRENT REV DESC: DRAWING CORRECTION | | | | | | | | | | | |
| MM | | 2:1 | | | | | | | | | | | | | |
| GENERAL TOLERANCES (UNLESS SPECIFIED) | | | | EC NO: 728054 | | | | 1.00MM CENTER FLAT FLEX CABLE (FFC) (EXTRA FLEXIBLE, 105°C, SN PLATED) SALES DRAWING | | | | | | | |
| | | mm | INCH | DRWN: DIEGOG7 | | 2022/11/10 | | | | | | | | | |
| 4 PLACES | | ±---- | ±---- | CHK'D: JSMITH11 | | 2022/11/14 | | PRODUCT CUSTOMER DRAWING | | | | | | | |
| 3 PLACES | | ±---- | ±---- | APPR: JSMITH11 | | 2022/11/14 | | | | | | | | | |
| 2 PLACES | | ±---- | ±---- | INITIAL REVISION: | | | | DOCUMENT NUMBER: SD-15167-001 DOC TYPE: PSD DOC PART: 001 REVISION: B | | | | | | | |
| 1 PLACE | | ±---- | ±---- | DRWN: JLWOLFSB | | 2011/10/27 | | | | | | | | | |
| 0 PLACES | | ±---- | ±---- | APPR: SFULTON | | 2011/11/03 | | MATERIAL NUMBER: SEE CHART CUSTOMER: GENERAL MARKET SHEET NUMBER: 1 OF 2 | | | | | | | |
| ANGULAR TOL ± 0.5 ° | | | | THIRD ANGLE PROJECTION | | DRAWING: C-SIZE | | | | | | SERIES: 15167 | | | |
| DRAFT WHERE APPLICABLE MUST REMAIN WITHIN DIMENSIONS | | | | THIRD ANGLE PROJECTION | | DRAWING: C-SIZE | | SERIES: 15167 | | MATERIAL NUMBER: SEE CHART | | CUSTOMER: GENERAL MARKET | | SHEET NUMBER: 1 OF 2 | |

| | | | | |
|-----------------|----|--------------|------------|----------|
| DOCUMENT STATUS | P1 | RELEASE DATE | 2022/11/14 | 14:34:47 |
|-----------------|----|--------------|------------|----------|

1.00mm CENTER FLAT FLEX CABLE (FFC) (EXTRA FLEXIBLE, 105°C, Sn PLATED)

| "L" DIM. → | 30 ± 2 MM | | 51 ± 2 MM | | 76 ± 3 MM | | 102 ± 3 MM | | 127 ± 4 MM | | 152 ± 4 MM | | 178 ± 4 MM | | 203 ± 4 MM | | 229 ± 5 MM | | 254 ± 5 MM | | 305 ± 5 MM | | | |
|--------------|-------------|-----------|------------|-----------|------------|-----------|------------|-----------|------------|-----------|------------|-----------|------------|-----------|------------|-----------|------------|-----------|-------------|-----------|-------------|-----------|---|--|
| REF DIM → | (1.18 INCH) | | (2 INCHES) | | (3 INCHES) | | (4 INCHES) | | (5 INCHES) | | (6 INCHES) | | (7 INCHES) | | (8 INCHES) | | (9 INCHES) | | (10 INCHES) | | (12 INCHES) | | | |
| CABLE TYPE → | A | | D | | A | | D | | A | | D | | A | | D | | A | | D | | A | | D | |
| CIRCUITS ↓ | A | D | A | D | A | D | A | D | A | D | A | D | A | D | A | D | A | D | A | D | A | D | | |
| 5 | 151670723 | 151670722 | 151670725 | 151670724 | 151670727 | 151670726 | 151670729 | 151670728 | 151670731 | 151670730 | 151670733 | 151670732 | 151670735 | 151670734 | 151670737 | 151670736 | 151670739 | 151670738 | 151670741 | 151670740 | 151670743 | 151670742 | | |
| 7 | 151670745 | 151670744 | 151670747 | 151670746 | 151670749 | 151670748 | 151670751 | 151670750 | 151670753 | 151670752 | 151670755 | 151670754 | 151670757 | 151670756 | 151670759 | 151670758 | 151670761 | 151670760 | 151670763 | 151670762 | 151670765 | 151670764 | | |
| 9 | 151670767 | 151670766 | 151670769 | 151670768 | 151670771 | 151670770 | 151670773 | 151670772 | 151670775 | 151670774 | 151670777 | 151670776 | 151670779 | 151670778 | 151670781 | 151670780 | 151670783 | 151670782 | 151670785 | 151670784 | 151670787 | 151670786 | | |
| 11 | 151670789 | 151670788 | 151670791 | 151670790 | 151670793 | 151670792 | 151670795 | 151670794 | 151670797 | 151670796 | 151670799 | 151670798 | 151670801 | 151670800 | 151670803 | 151670802 | 151670805 | 151670804 | 151670807 | 151670806 | 151670809 | 151670808 | | |
| 13 | 151670811 | 151670810 | 151670813 | 151670812 | 151670815 | 151670814 | 151670817 | 151670816 | 151670819 | 151670818 | 151670821 | 151670820 | 151670823 | 151670822 | 151670825 | 151670824 | 151670827 | 151670826 | 151670829 | 151670828 | 151670831 | 151670830 | | |
| 15 | 151670833 | 151670832 | 151670835 | 151670834 | 151670837 | 151670836 | 151670839 | 151670838 | 151670841 | 151670840 | 151670843 | 151670842 | 151670845 | 151670844 | 151670847 | 151670846 | 151670849 | 151670848 | 151670851 | 151670850 | 151670853 | 151670852 | | |
| 17 | 151670855 | 151670854 | 151670857 | 151670856 | 151670859 | 151670858 | 151670861 | 151670860 | 151670863 | 151670862 | 151670865 | 151670864 | 151670867 | 151670866 | 151670869 | 151670868 | 151670871 | 151670870 | 151670873 | 151670872 | 151670875 | 151670874 | | |
| 19 | 151670877 | 151670876 | 151670879 | 151670878 | 151670881 | 151670880 | 151670883 | 151670882 | 151670885 | 151670884 | 151670887 | 151670886 | 151670889 | 151670888 | 151670891 | 151670890 | 151670893 | 151670892 | 151670895 | 151670894 | 151670897 | 151670896 | | |
| 21 | 151670899 | 151670898 | 151670901 | 151670900 | 151670903 | 151670902 | 151670905 | 151670904 | 151670907 | 151670906 | 151670909 | 151670908 | 151670911 | 151670910 | 151670913 | 151670912 | 151670915 | 151670914 | 151670917 | 151670916 | 151670919 | 151670918 | | |
| 23 | 151670921 | 151670920 | 151670923 | 151670922 | 151670925 | 151670924 | 151670927 | 151670926 | 151670929 | 151670928 | 151670931 | 151670930 | 151670933 | 151670932 | 151670935 | 151670934 | 151670937 | 151670936 | 151670939 | 151670938 | 151670941 | 151670940 | | |
| 25 | 151670943 | 151670942 | 151670945 | 151670944 | 151670947 | 151670946 | 151670949 | 151670948 | 151670951 | 151670950 | 151670953 | 151670952 | 151670955 | 151670954 | 151670957 | 151670956 | 151670959 | 151670958 | 151670961 | 151670960 | 151670963 | 151670962 | | |
| 27 | 151670965 | 151670964 | 151670967 | 151670966 | 151670969 | 151670968 | 151670971 | 151670970 | 151670973 | 151670972 | 151670975 | 151670974 | 151670977 | 151670976 | 151670979 | 151670978 | 151670981 | 151670980 | 151670983 | 151670982 | 151670985 | 151670984 | | |
| 29 | 151670987 | 151670986 | 151670989 | 151670988 | 151670991 | 151670990 | 151670993 | 151670992 | 151670995 | 151670994 | 151670997 | 151670996 | 151670999 | 151670998 | 151671001 | 151671000 | 151671003 | 151671002 | 151671005 | 151671004 | 151671007 | 151671006 | | |
| 31 | 151671009 | 151671008 | 151671011 | 151671010 | 151671013 | 151671012 | 151671015 | 151671014 | 151671017 | 151671016 | 151671019 | 151671018 | 151671021 | 151671020 | 151671023 | 151671022 | 151671025 | 151671024 | 151671027 | 151671026 | 151671029 | 151671028 | | |
| 33 | 151671031 | 151671030 | 151671033 | 151671032 | 151671035 | 151671034 | 151671037 | 151671036 | 151671039 | 151671038 | 151671041 | 151671040 | 151671043 | 151671042 | 151671045 | 151671044 | 151671047 | 151671046 | 151671049 | 151671048 | 151671051 | 151671050 | | |
| 35 | 151671053 | 151671052 | 151671055 | 151671054 | 151671057 | 151671056 | 151671059 | 151671058 | 151671061 | 151671060 | 151671063 | 151671062 | 151671065 | 151671064 | 151671067 | 151671066 | 151671069 | 151671068 | 151671071 | 151671070 | 151671073 | 151671072 | | |
| 37 | 151671075 | 151671074 | 151671077 | 151671076 | 151671079 | 151671078 | 151671081 | 151671080 | 151671083 | 151671082 | 151671085 | 151671084 | 151671087 | 151671086 | 151671089 | 151671088 | 151671091 | 151671090 | 151671093 | 151671092 | 151671095 | 151671094 | | |
| 39 | 151671097 | 151671096 | 151671099 | 151671098 | 151671101 | 151671100 | 151671103 | 151671102 | 151671105 | 151671104 | 151671107 | 151671106 | 151671109 | 151671108 | 151671111 | 151671110 | 151671113 | 151671112 | 151671115 | 151671114 | 151671117 | 151671116 | | |

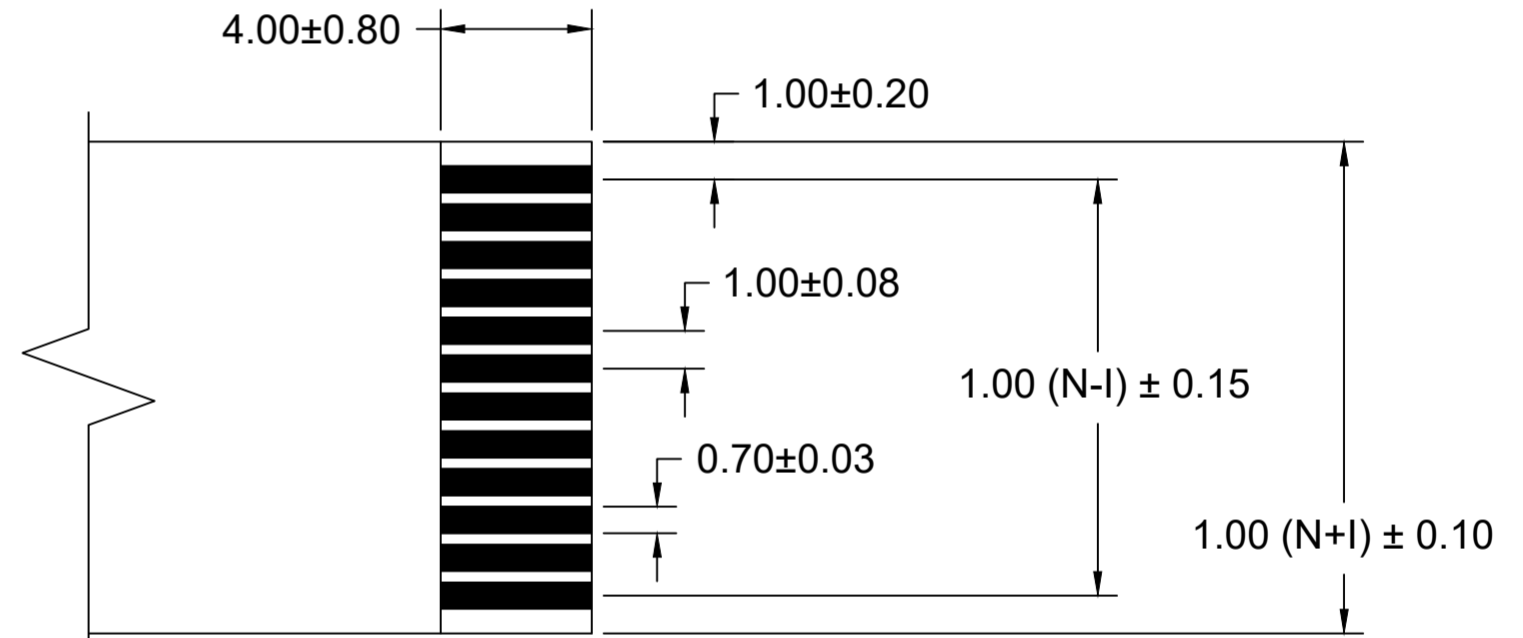
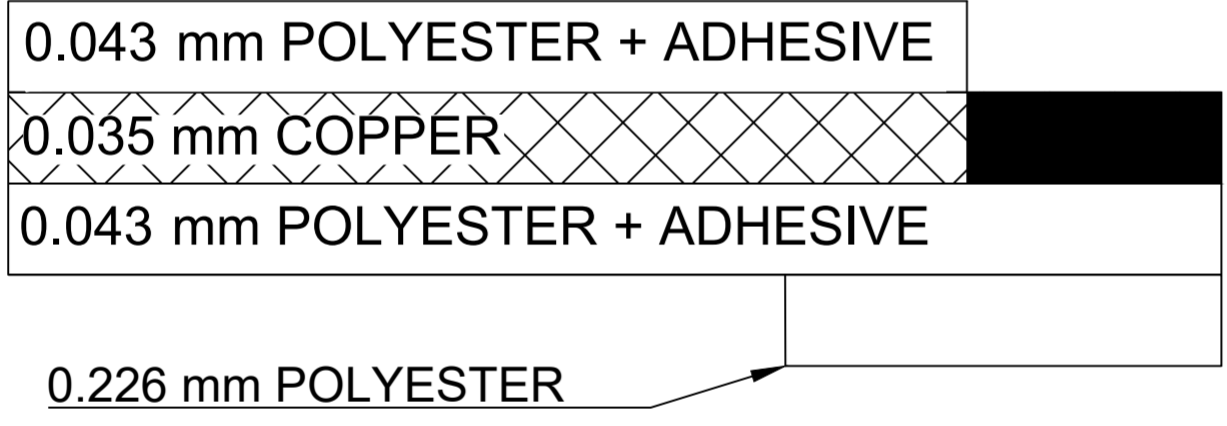

NOTES:
1. NO PRINTING ON JUMPER CABLE UNLESS OTHERWISE SPECIFIED. IF PRINTING IS REQUIRED, THEN IT WOULD BE CONSIDERED A SPECIAL JUMPER CABLE.

| | | | | | | | | | |
|---|-------|-------|-------|--|--|----------------|--|-----------------|--|
| THIS DRAWING CONTAINS INFORMATION THAT IS PROPRIETARY TO MOLEX ELECTRONIC TECHNOLOGIES, LLC AND SHOULD NOT BE USED WITHOUT WRITTEN PERMISSION | | | | | | | | | |
| DIMENSION UNITS | | SCALE | | CURRENT REV DESC: DRAWING CORRECTION | | | | | |
| MM | | NA | | <p>molex</p> <p>1.00MM CENTER FLAT FLEX CABLE (FFC) (EXTRA FLEXIBLE, 105°C, SN PLATED) SALES DRAWING</p> <p>PRODUCT CUSTOMER DRAWING</p> <p>DOCUMENT NUMBER: SD-15167-001 DOC TYPE: PSD DOC PART: 001 REVISION: B</p> | | | | | |
| GENERAL TOLERANCES (UNLESS SPECIFIED) | | | | | | | | | |
| | mm | | INCH | | | | | | |
| 4 PLACES | ±---- | | ±---- | | | | | | |
| 3 PLACES | ±---- | | ±---- | | | | | | |
| 2 PLACES | ±---- | | ±---- | | | | | | |
| 1 PLACE | ±---- | | ±---- | | | | | | |
| 0 PLACES | ±---- | | ±---- | | | | | | |
| ANGULAR TOL ± 0.5 ° | | | | EC NO: 728054 | | DRWN: DIEGOG7 | | 2022/11/10 | |
| DRAFT WHERE APPLICABLE MUST REMAIN WITHIN DIMENSIONS | | | | THIRD ANGLE PROJECTION | | DRAWING | | SERIES | |
| | | | | C-SIZE | | 15167 | | MATERIAL NUMBER | |
| | | | | | | GENERAL MARKET | | CUSTOMER | |
| | | | | | | 2 OF 2 | | SHEET NUMBER | |