



Distanzbolzen

Messing
 mit Innengewinde
M2 - M5

Entretoises hexagonales

laiton
 avec filet femelle
M2 - M5

Spacers

brass
 with inside thread
M2 - M5

Werkstoff:
 MS ni = Messing vernickelt

Matière:
 MS ni = laiton nickelé

Material:
 MS ni = nickel-plated brass

Bestellbeispiel:
 Exemple de commande:
 Example of order:

M20005.00.65
 (M2 x 5 x 4 MS ni)

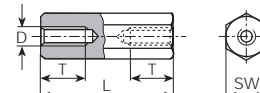
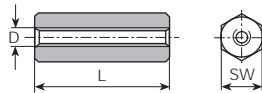

| D mm | L mm | SW mm | Stand.-Packg. | Artikel-Nr. Numéro d'article Part-No. |
|-----------|-------------|----------|---------------|---|
| M2 | 5 | 4 | 500 | M20005.00.65 |
| | 6 | 4 | 200 | M20006.00.65 |
| | 7 | 4 | 200 | M20007.00.65 |
| | 8 | 4 | 200 | M20008.00.65 |
| | 10 | 4 | 200 | M20010.00.65 |
| | 12 | 4 | 200 | M20012.00.65 |
| | 15 | 4 | 200 | M20015.00.65 |
| | 18 | 4 | 200 | M20018.00.65 |
| | 20 | 4 | 200 | M20020.00.65 |
| | M2.5 | 5 | 5 | 500 |
| 8 | | 5 | 200 | M25008.00.65 |
| 10 | | 5 | 200 | M25010.00.65 |
| 12 | | 5 | 200 | M25012.00.65 |
| 15 | | 5 | 200 | M25015.00.65 |
| 18 | | 5 | 200 | M25018.00.65 |
| 20 | | 5 | 200 | M25020.00.65 |
| M3 | | 5 | 5 | 500 |
| | 6 | 5 | 500 | M30006.00.65 |
| | 7 | 5 | 500 | M30007.00.65 |
| | 8 | 5 | 200 | M30008.00.65 |
| | 10 | 5 | 200 | M30010.00.65 |
| | 11 | 5 | 200 | M30011.00.65 |
| | 12 | 5 | 200 | M30012.00.65 |
| | 13 | 5 | 200 | M30013.00.65 |
| | 14 | 5 | 200 | M30014.00.65 |
| | 15 | 5 | 200 | M30015.00.65 |
| | 16 | 5 | 200 | M30016.00.65 |
| | 18 | 5 | 200 | M30018.00.65 |
| | 20 | 5 | 200 | M30020.00.65 |
| | M4 | 10 | 7 | 200 |
| 12 | | 7 | 200 | M40012.00.65 |
| 13 | | 7 | 200 | M40013.00.65 |
| 14 | | 7 | 200 | M40014.00.65 |
| 15 | | 7 | 200 | M40015.00.65 |
| 16 | | 7 | 200 | M40016.00.65 |
| 18 | | 7 | 200 | M40018.00.65 |
| 19 | | 7 | 200 | M40019.00.65 |
| 20 | | 7 | 200 | M40020.00.65 |
| 21 | | 7 | 200 | M40021.00.65 |
| M5 | | 10 | 8 | 100 |
| | 12 | 8 | 100 | M50012.00.65 |
| | 15 | 8 | 100 | M50015.00.65 |
| | 20 | 8 | 100 | M50020.00.65 |

| D mm | L mm | SW mm | T mm | Stand.-Packg. | Artikel-Nr. Numéro d'article Part-No. |
|-------------|---------|----------|---------|---------------------|---|
| M2 | 25 | 4 | 10 | 200 | M20025.00.65 |
| | 30 | 4 | 10 | 200 | M20030.00.65 |
| | 35 | 4 | 10 | 100 | M20035.00.65 |
| | 40 | 4 | 10 | 100 | M20040.00.65 |
| | 45 | 4 | 10 | 100 | M20045.00.65 |
| M2.5 | 25 | 5 | 10 | 200 | M25025.00.65 |
| | 30 | 5 | 10 | 200 | M25030.00.65 |
| | 35 | 5 | 10 | 100 | M25035.00.65 |
| | 40 | 5 | 10 | 100 | M25040.00.65 |
| | 45 | 5 | 10 | 100 | M25045.00.65 |
| M3 | 25 | 5 | 10 | 200 | M30025.00.65 |
| | 27 | 5 | 10 | 200 | M30027.00.65 |
| | 30 | 5 | 10 | 200 | M30030.00.65 |
| | 33 | 5 | 10 | 200 | M30033.00.65 |
| | 35 | 5 | 10 | 100 | M30035.00.65 |
| | 37 | 5 | 10 | 100 | M30037.00.65 |
| | 40 | 5 | 10 | 100 | M30040.00.65 |
| | 45 | 5 | 10 | 100 | M30045.00.65 |
| | 50 | 5 | 10 | 100 | M30050.00.65 |
| | 55 | 5 | 10 | 100 | M30055.00.65 |
| | 60 | 5 | 10 | 100 | M30060.00.65 |
| M4 | 25 | 7 | 10 | 200 | M40025.00.65 |
| | 30 | 7 | 10 | 200 | M40030.00.65 |
| | 35 | 7 | 10 | 100 | M40035.00.65 |
| | 40 | 7 | 10 | 100 | M40040.00.65 |
| | 45 | 7 | 10 | 100 | M40045.00.65 |
| | 50 | 7 | 10 | 50 | M40050.00.65 |
| | 55 | 7 | 10 | 50 | M40055.00.65 |
| | 60 | 7 | 10 | 50 | M40060.00.65 |
| M5 | 25 | 8 | 10 | 100 | M50025.00.65 |
| | 30 | 8 | 10 | 50 | M50030.00.65 |
| | 35 | 8 | 10 | 50 | M50035.00.65 |
| | 40 | 8 | 10 | 50 | M50040.00.65 |
| | 45 | 8 | 10 | 50 | M50045.00.65 |
| | 50 | 8 | 10 | 50 | M50050.00.65 |
| | 55 | 8 | 10 | 50 | M50055.00.65 |
| | 60 | 8 | 10 | 50 | M50060.00.65 |
| | 70 | 8 | 10 | 50 | M50070.00.65 |
| | 80 | 8 | 10 | 20 | M50080.00.65 |
| | 90 | 8 | 10 | 20 | M50090.00.65 |
| 100 | 8 | 10 | 20 | M50100.00.65 | |

Andere Abmessungen auf Anfrage

Autres dimensions sur demande

Further dimensions on request



Distanzbolzen

Messing vernickelt
mit Innen- und Aussengewinde
M2 - M5

Entretoises hexagonales

laiton nickelé
avec filet femelle et mâle
M2 - M5

Spacers

nickel-plated brass
with inside and outside thread
M2 - M5

Bestellbeispiel:
Exemple de commande:
Example of order:

M20005.01.65
(M2 x 5 x 4 x 2.5 x 6 MS ni)

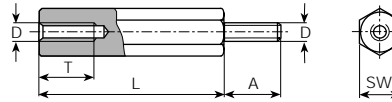

| D mm | L mm | SW mm | T mm | A mm | Stand.-Packg. | Artikel-Nr. Numéro d'article Part-No. | D mm | L mm | SW mm | T mm | A mm | Stand.-Packg. | Artikel-Nr. Numéro d'article Part-No. |
|------|------|-------|------|------|---------------|---|------|------|-------|------|------|---------------|---|
| M2 | 5 | 4 | 2.5 | 6 | 500 | M20005.01.65 | M4 | 10 | 7 | 5 | 8 | 100 | M40010.01.65 |
| | 8 | 4 | 5 | 6 | 500 | M20008.01.65 | | 12 | 7 | 8 | 8 | 100 | M40012.01.65 |
| | 10 | 4 | 5 | 6 | 200 | M20010.01.65 | | 14 | 7 | 10 | 8 | 100 | M40014.01.65 |
| | 12 | 4 | 6 | 6 | 200 | M20012.01.65 | | 15 | 7 | 10 | 8 | 100 | M40015.01.65 |
| | 15 | 4 | 6 | 6 | 200 | M20015.01.65 | | 16 | 7 | 10 | 8 | 100 | M40016.01.65 |
| | 18 | 4 | 6 | 6 | 200 | M20018.01.65 | | 18 | 7 | 10 | 8 | 100 | M40018.01.65 |
| | 20 | 4 | 6 | 6 | 200 | M20020.01.65 | | 20 | 7 | 10 | 8 | 100 | M40020.01.65 |
| | 25 | 4 | 6 | 6 | 100 | M20025.01.65 | | 25 | 7 | 10 | 10 | 100 | M40025.01.65 |
| | 30 | 4 | 6 | 6 | 100 | M20030.01.65 | | 30 | 7 | 10 | 10 | 100 | M40030.01.65 |
| | 35 | 4 | 6 | 6 | 100 | M20035.01.65 | | 35 | 7 | 10 | 10 | 100 | M40035.01.65 |
| | 40 | 4 | 6 | 6 | 100 | M20040.01.65 | | 40 | 7 | 10 | 10 | 100 | M40040.01.65 |
| M2.5 | 5 | 5 | 2.5 | 6 | 500 | M25005.01.65 | 45 | 7 | 10 | 10 | 50 | M40045.01.65 | |
| | 8 | 5 | 5 | 6 | 500 | M25008.01.65 | 50 | 7 | 10 | 10 | 50 | M40050.01.65 | |
| | 10 | 5 | 5 | 6 | 200 | M25010.01.65 | 55 | 7 | 10 | 10 | 50 | M40055.01.65 | |
| | 12 | 5 | 6 | 6 | 200 | M25012.01.65 | 60 | 7 | 10 | 10 | 50 | M40060.01.65 | |
| | 15 | 5 | 6 | 6 | 200 | M25015.01.65 | 70 | 7 | 10 | 10 | 50 | M40070.01.65 | |
| | 18 | 5 | 6 | 6 | 200 | M25018.01.65 | 80 | 7 | 10 | 10 | 50 | M40080.01.65 | |
| | 20 | 5 | 6 | 6 | 200 | M25020.01.65 | 100 | 7 | 10 | 10 | 50 | M40100.01.65 | |
| | 25 | 5 | 6 | 6 | 100 | M25025.01.65 | M5 | 15 | 8 | 10 | 8 | 100 | M50015.01.65 |
| | 30 | 5 | 6 | 6 | 100 | M25030.01.65 | | 16 | 8 | 10 | 8 | 50 | M50016.01.65 |
| | 35 | 5 | 6 | 6 | 100 | M25035.01.65 | | 18 | 8 | 10 | 8 | 50 | M50018.01.65 |
| | 40 | 5 | 6 | 6 | 100 | M25040.01.65 | | 20 | 8 | 10 | 8 | 50 | M50020.01.65 |
| M3 | 5 | 5 | 3 | 5 | 500 | M30005.01.65 | | 25 | 8 | 10 | 10 | 50 | M50025.01.65 |
| | 8 | 5 | 5 | 6 | 500 | M30008.01.65 | | 30 | 8 | 10 | 10 | 50 | M50030.01.65 |
| | 10 | 5 | 6 | 8 | 200 | M30010.01.65 | | 35 | 8 | 10 | 10 | 50 | M50035.01.65 |
| | 11 | 5 | 6 | 8 | 200 | M30011.01.65 | | 40 | 8 | 10 | 10 | 50 | M50040.01.65 |
| | 12 | 5 | 8 | 8 | 200 | M30012.01.65 | | 45 | 8 | 10 | 10 | 50 | M50045.01.65 |
| | 14 | 5 | 8 | 8 | 200 | M30014.01.65 | | 50 | 8 | 10 | 10 | 50 | M50050.01.65 |
| | 15 | 5 | 8 | 8 | 200 | M30015.01.65 | | 55 | 8 | 10 | 10 | 50 | M50055.01.65 |
| | 16 | 5 | 8 | 8 | 200 | M30016.01.65 | 60 | 8 | 10 | 10 | 50 | M50060.01.65 | |
| | 17 | 5 | 8 | 8 | 200 | M30017.01.65 | 70 | 8 | 10 | 10 | 50 | M50070.01.65 | |
| | 18 | 5 | 8 | 8 | 200 | M30018.01.65 | 80 | 8 | 10 | 10 | 20 | M50080.01.65 | |
| | 20 | 5 | 8 | 8 | 200 | M30020.01.65 | 90 | 8 | 10 | 10 | 20 | M50090.01.65 | |
| | 22 | 5 | 10 | 8 | 200 | M30022.01.65 | 100 | 8 | 10 | 10 | 20 | M50100.01.65 | |
| | 25 | 5 | 10 | 10 | 100 | M30025.01.65 | | | | | | | |
| | 30 | 5 | 10 | 10 | 100 | M30030.01.65 | | | | | | | |
| | 32 | 5 | 10 | 6 | 100 | M30032.01.65 | | | | | | | |
| | 35 | 5 | 10 | 10 | 100 | M30035.01.65 | | | | | | | |
| | 40 | 5 | 10 | 10 | 100 | M30040.01.65 | | | | | | | |
| | 45 | 5 | 10 | 10 | 100 | M30045.01.65 | | | | | | | |
| 50 | 5 | 10 | 10 | 100 | M30050.01.65 | | | | | | | | |

Andere Abmessungen auf Anfrage

Autres dimensions sur demande

Further dimensions on request

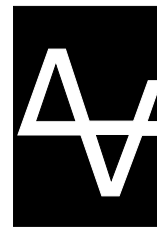

Distanzbolzen

Messing vernickelt
mit Innengewinde
M3 (EU)

Entretoises hexagonales

laiton nickelé
avec filet femelle
M3 (EU)

Spacers

nickel-plated brass
with inside thread
M3 (EU)

Bestellbeispiel:
Exemple de commande:
Example of order:

M30005.50.65
(M3 x 5 x 5.5 MS ni)

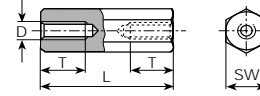
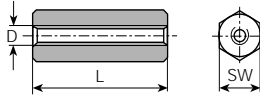

| D mm | L mm | SW mm | Stand.-Packg. | Artikel-Nr. Numéro d'article Part-No. |
|------|------|-------|---------------|---|
| M3 | 5 | 5.5 | 500 | M30005.50.65 |
| | 6 | 5.5 | 500 | M30006.50.65 |
| | 7 | 5.5 | 500 | M30007.50.65 |
| | 8 | 5.5 | 200 | M30008.50.65 |
| | 10 | 5.5 | 200 | M30010.50.65 |
| | 11 | 5.5 | 200 | M30011.50.65 |
| | 12 | 5.5 | 200 | M30012.50.65 |
| | 13 | 5.5 | 200 | M30013.50.65 |
| | 14 | 5.5 | 200 | M30014.50.65 |
| | 15 | 5.5 | 200 | M30015.50.65 |
| | 18 | 5.5 | 200 | M30018.50.65 |
| | 20 | 5.5 | 200 | M30020.50.65 |

| D mm | L mm | SW mm | T mm | Stand.-Packg. | Artikel-Nr. Numéro d'article Part-No. |
|------|------|-------|------|---------------|---|
| M3 | 25 | 5.5 | 10 | 200 | M30025.50.65 |
| | 30 | 5.5 | 10 | 200 | M30030.50.65 |
| | 35 | 5.5 | 10 | 100 | M30035.50.65 |
| | 40 | 5.5 | 10 | 100 | M30040.50.65 |
| | 45 | 5.5 | 10 | 100 | M30045.50.65 |
| | 50 | 5.5 | 10 | 100 | M30050.50.65 |
| | 55 | 5.5 | 10 | 100 | M30055.50.65 |
| | 60 | 5.5 | 10 | 100 | M30060.50.65 |

Distanzbolzen

Messing vernickelt
mit Innen- und Aussengewinde
M3 (EU)

Entretoises hexagonales

laiton nickelé
avec filet femelle et mâle
M3 (EU)

Spacers

nickel-plated brass
with inside and outside thread
M3 (EU)

Bestellbeispiel:
Exemple de commande:
Example of order:

M30005.51.65
(M3 x 5 x 5.5 x 3 x 8 MS ni)

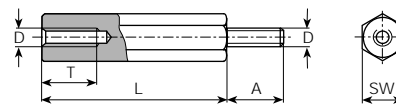

| D mm | L mm | SW mm | T mm | A mm | Stand.-Packg. | Artikel-Nr. Numéro d'article Part-No. |
|------|------|-------|------|------|---------------|---|
| M3 | 5 | 5.5 | 3 | 8 | 500 | M30005.51.65 |
| | 8 | 5.5 | 5 | 8 | 500 | M30008.51.65 |
| | 10 | 5.5 | 6 | 8 | 200 | M30010.51.65 |
| | 11 | 5.5 | 6 | 8 | 200 | M30011.51.65 |
| | 12 | 5.5 | 8 | 8 | 200 | M30012.51.65 |
| | 14 | 5.5 | 8 | 8 | 200 | M30014.51.65 |
| | 15 | 5.5 | 8 | 8 | 200 | M30015.51.65 |
| | 18 | 5.5 | 8 | 8 | 200 | M30018.51.65 |
| | 20 | 5.5 | 8 | 8 | 200 | M30020.51.65 |
| | 25 | 5.5 | 10 | 10 | 100 | M30025.51.65 |
| | 30 | 5.5 | 10 | 10 | 100 | M30030.51.65 |
| | 35 | 5.5 | 10 | 10 | 100 | M30035.51.65 |
| | 40 | 5.5 | 10 | 10 | 100 | M30040.51.65 |
| | 45 | 5.5 | 10 | 10 | 100 | M30045.51.65 |
| | 50 | 5.5 | 10 | 10 | 100 | M30050.51.65 |

Andere Abmessungen auf Anfrage

Autres dimensions sur demande

Further dimensions on request